

TG-06 Plastic Micro Gear Pump (DC brush motor)



Specification:

small size, high pressure

Working Way :

interruption

Fluid Temperature:

$-10\text{ }^{\circ}\text{C} \leq T \leq 70\text{ }^{\circ}\text{C}$ (except for the freezing)

Application:

spray,
personal care cleaner,
plus water system of vacuum cleaner
sanitary , and so on

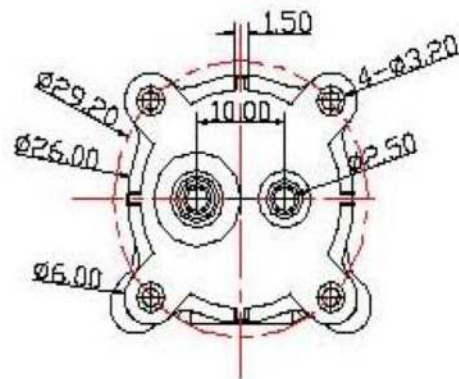
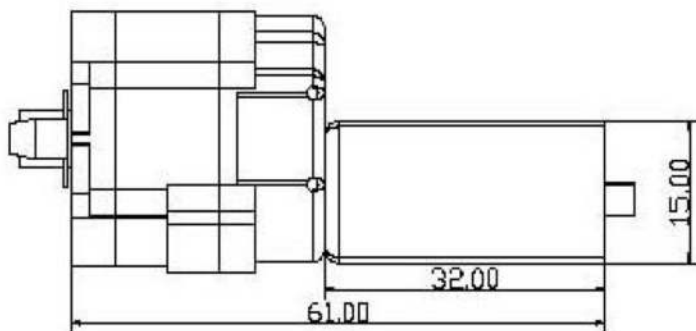

Model	Voltage (V)		Max Water Head (M)	Max Flow Rate (ml/min)	Power (W)
	Scope (V)	Rated			
TG-06/DC3	1.5~33	V	≥8M	500	≤3 W
TG-06/DC7.2	6~8	7.2V	≥10M	550	≤3 W
TG-06/DC12	10~13	12V	≥10M	600	≤3 W
TG-06/DC24	18~25	24V	≥10M	600	≤3 W